

**CBRHDSH2-40**  
**HIGH DENSITY**  
**2.0 AMP DUAL IN LINE**  
**SCHOTTKY BRIDGE RECTIFIER**

**HD**BRIDGE

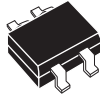

**HD DIP CASE**

# Central<sup>TM</sup>

**Semiconductor Corp.**

**DESCRIPTION:**

The CENTRAL SEMICONDUCTOR CBRHDSH2-40 is a full wave bridge rectifier mounted in a durable epoxy surface mount molded case, utilizing glass passivated chips.

**MARKING CODE: CSH2**

**FEATURES:**

- Low Leakage Current (20 $\mu$ A TYP @  $V_{RRM}$ )
- High 2.0A Current Rating
- Low  $V_F$  Schottky Diodes (500mV MAX @  $I_F=2.0A$ )

**MAXIMUM RATINGS:** ( $T_A=25^\circ\text{C}$  unless otherwise noted)

	<b>SYMBOL</b>		<b>UNITS</b>
Peak Repetitive Reverse Voltage	$V_{RRM}$	40	V
DC Blocking Voltage	$V_R$	40	V
RMS Reverse Voltage	$V_{R(RMS)}$	28	V
Average Forward Current	$I_O$	2.0	A
Peak Forward Surge Current	$I_{FSM}$	30	A
Power Dissipation	$P_D$	2.0	W
Operating Junction Temperature Range	$T_J$	-50 to +125	$^\circ\text{C}$
Storage Temperature Range	$T_{stg}$	-50 to +150	$^\circ\text{C}$
Thermal Resistance	$\Theta_{JA}$	50	$^\circ\text{C/W}$

**ELECTRICAL CHARACTERISTICS PER DIODE:** ( $T_A=25^\circ\text{C}$  unless otherwise noted)

<b>SYMBOL</b>	<b>TEST CONDITIONS</b>	<b>TYP</b>	<b>MAX</b>	<b>UNITS</b>
$I_R$	$V_R=40V$	20	50	$\mu\text{A}$
$I_R$	$V_R=40V, T_A=100^\circ\text{C}$	5.0	20	mA
$V_F$	$I_F=2.0A$	450	500	mV
$C_J$	$V_R=4.0V, f=1.0\text{MHz}$		250	pF

HD DIP CASE - MECHANICAL OUTLINE

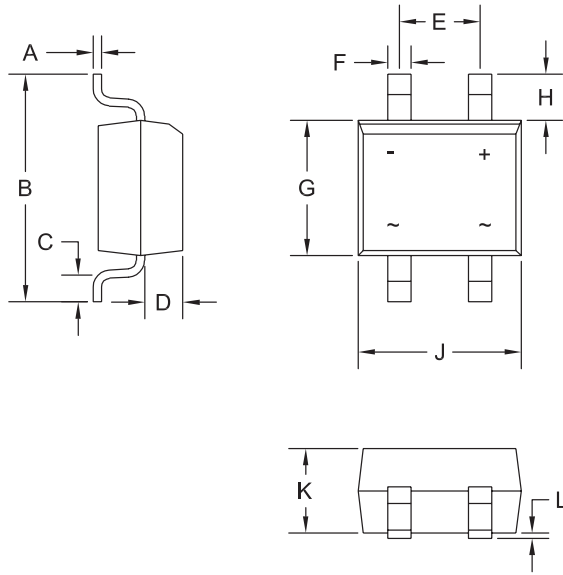

R2

SYMBOL	INCHES		MILLIMETERS	
	MIN	MAX	MIN	MAX
A	0.006	0.014	0.15	0.35
B	-	0.275	-	7.00
C	0.027	0.043	0.70	1.10
D	0.035	0.051	0.90	1.30
E	0.090	0.106	2.30	2.70
F	0.019	0.031	0.50	0.80
G	0.150	0.165	3.80	4.20
H	0.051	0.067	1.30	1.70
J	0.177	0.193	4.50	4.90
K	0.090	0.106	2.30	2.70
L	0.000	0.008	0.00	0.20

HD DIP (REV: R2)

MARKING CODE: CSH2

R3 (5-May 2009)

**TYPICAL ELECTRICAL CHARACTERISTICS**

**Typical Per Diode Leakage Current**

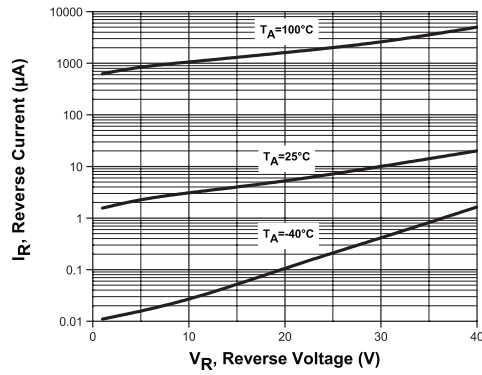

**Typical Per Diode Forward Voltage**

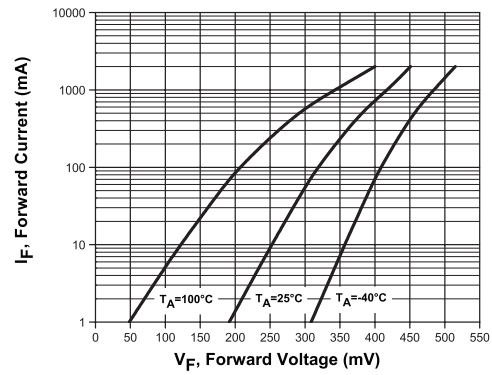

**Typical Per Diode Capacitance**

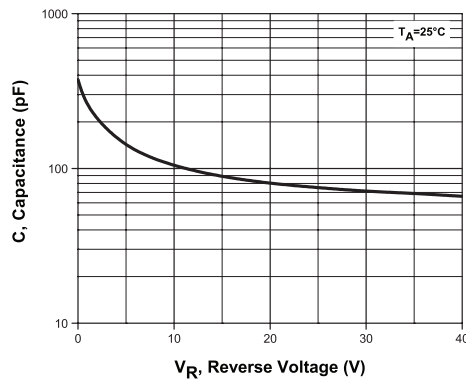

**Per Diode Current Derating**

